

1 1/4"

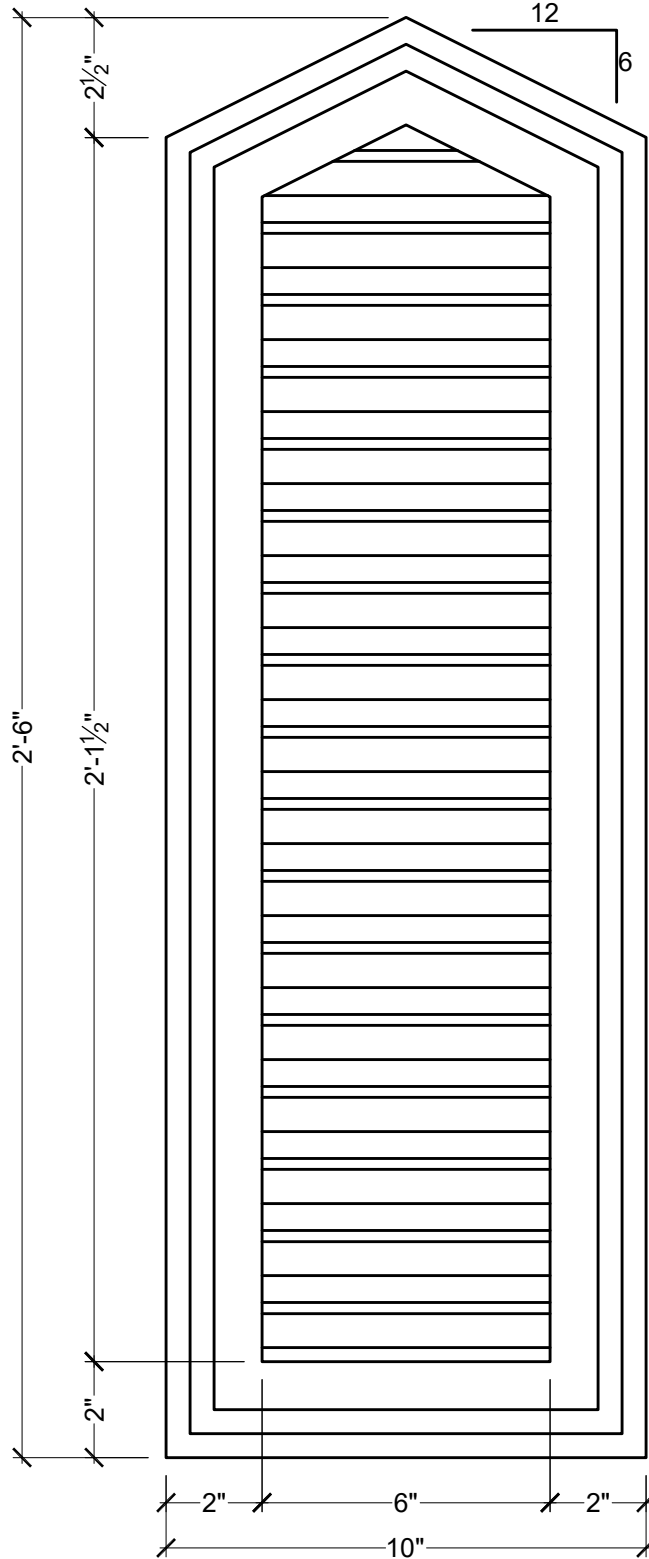

**GENERAL NOTES:**  
 -SPECTIS ADHESIVE MUST BE USED ON ALL BEDDING/BUTT JOINTS

**SPECTIS MOULDERS INC.**  
 P.O. BOX 970  
 100 CEDAR DRIVE  
 NIVERVILLE, MANITOBA  
 CANADA R0A 1E0

PHONE: 204-388-6700  
 PHONE: 800-685-9981  
 FAX: 204-388-6710

BOX 479  
 PEMBINA,  
 NORTH DAKOTA  
 58271-0479  
 U.S.A

**GENERAL NOTES:**  
 1. ALL PRODUCTS ARE DRAWN FOR PRESENTATION PURPOSES, ONLY IMAGE MAY VARY SLIGHTLY FROM ACTUAL PART  
 2. DRAWING INTENT IS TO INDICATE GENERAL ARRANGEMENT, DESIGN AND INTENT OF WORK IS PARTLY DIAGRAMATIC.  
 3. SPECTIS RESERVES THE RIGHT TO CHANGE ANY PRODUCT DESIGN WITHOUT

CUSTOMER NAME: STANDARD PRODUCT		PART: LOP1030	
REFERENCE: OPEN LOUVRE		SHEET: 01 OF 01	
DRAWN BY: JB/JK	DATE: 10/09/07	SCALE: 1/4 = 1"	REV:

© 2006, Spectis Moulders Inc. All rights reserved. This document may not be